



**THE MINT**  
SAN FRANCISCO



**THE MINT**

MANAGED BY **non plus ultra+**



## HISTORIC + ELEGANT + VERSATILE

Once home to 3/4 of the nation's gold reserve, this landmark Greek Revival gem offers highly adaptable space for almost any event. With 52,000 square feet of ballrooms, gold vaults, and large outdoor courtyard, **The Mint** has been carefully renovated to operate as an event venue without losing any of its historical grandeur. Originally built in 1874, the Mint is located in the heart of downtown San Francisco, and only minutes away from the Moscone Center.



# CAPACITY

## LOCATION

## CAPACITY

## SQUARE FEET

+ Full Venue

999

52,000

+ Main Floor

700

20,640

+ Vault Level

299

20,640

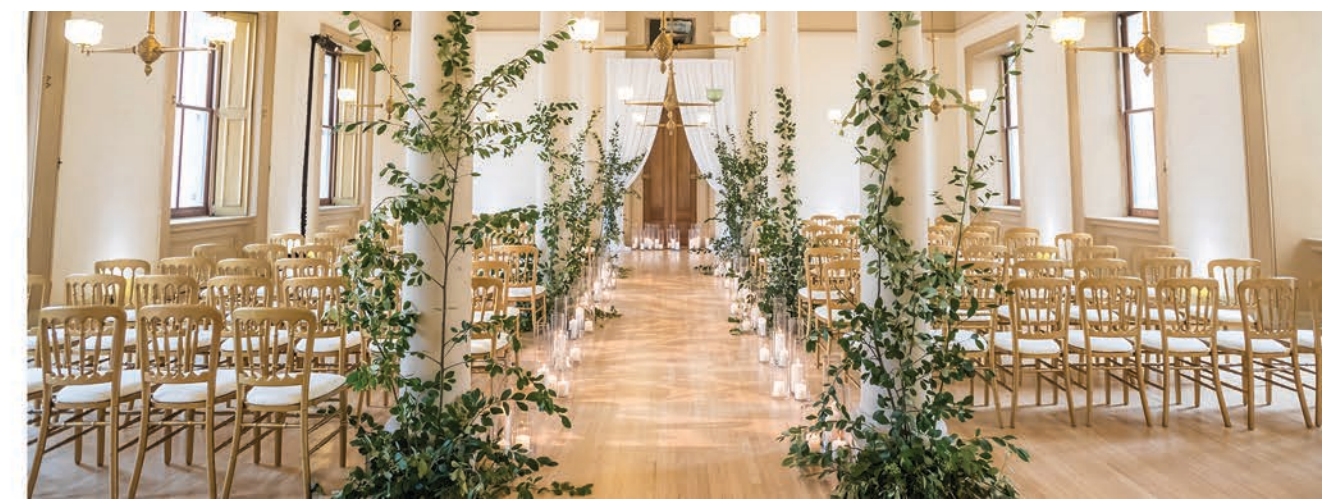

# DIMENSIONS

- + CEILING HEIGHT 30'
- + LOADING DOOR 5'9" x 9'9"
- + MAIN ENTRANCE 5'7" x 12'10"
- + ADA / FREIGHT ELEVATOR 3'4" x 7'10"





# DETAILS

+ **ADDRESS**

88 5th Street, San Francisco, CA 94103

+ **POWER**

Dedicated 400 amp circuit + 100 and 60 amp circuits

+ **WI-FI**

Up to 1 Gbps

+ **PARKING**

Public parking garage at 5th Street and Mission

+ **VENDORS**

Ask about our list of preferred vendors, or bring your own

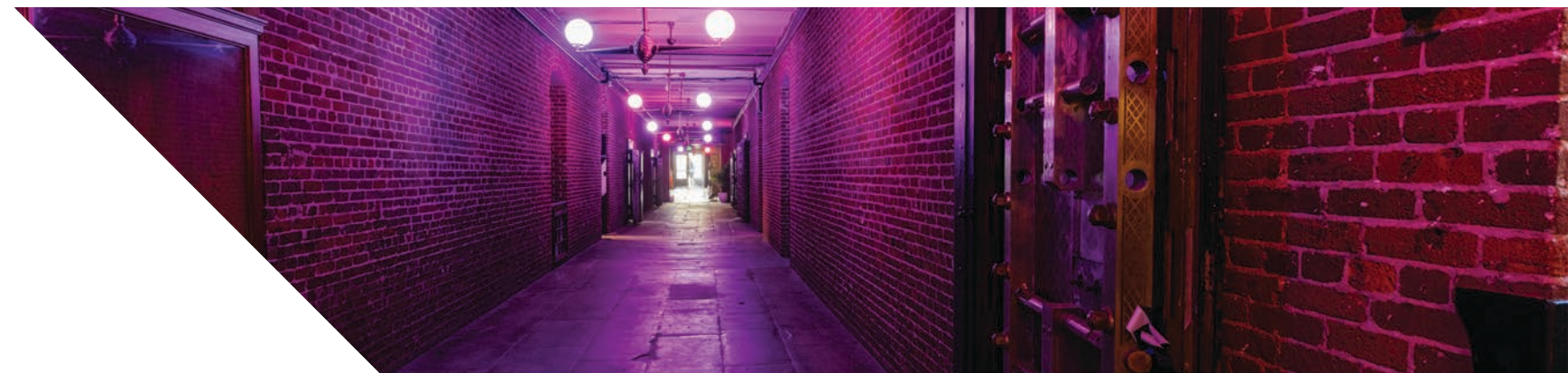

# LAYOUT

## MAIN FLOOR

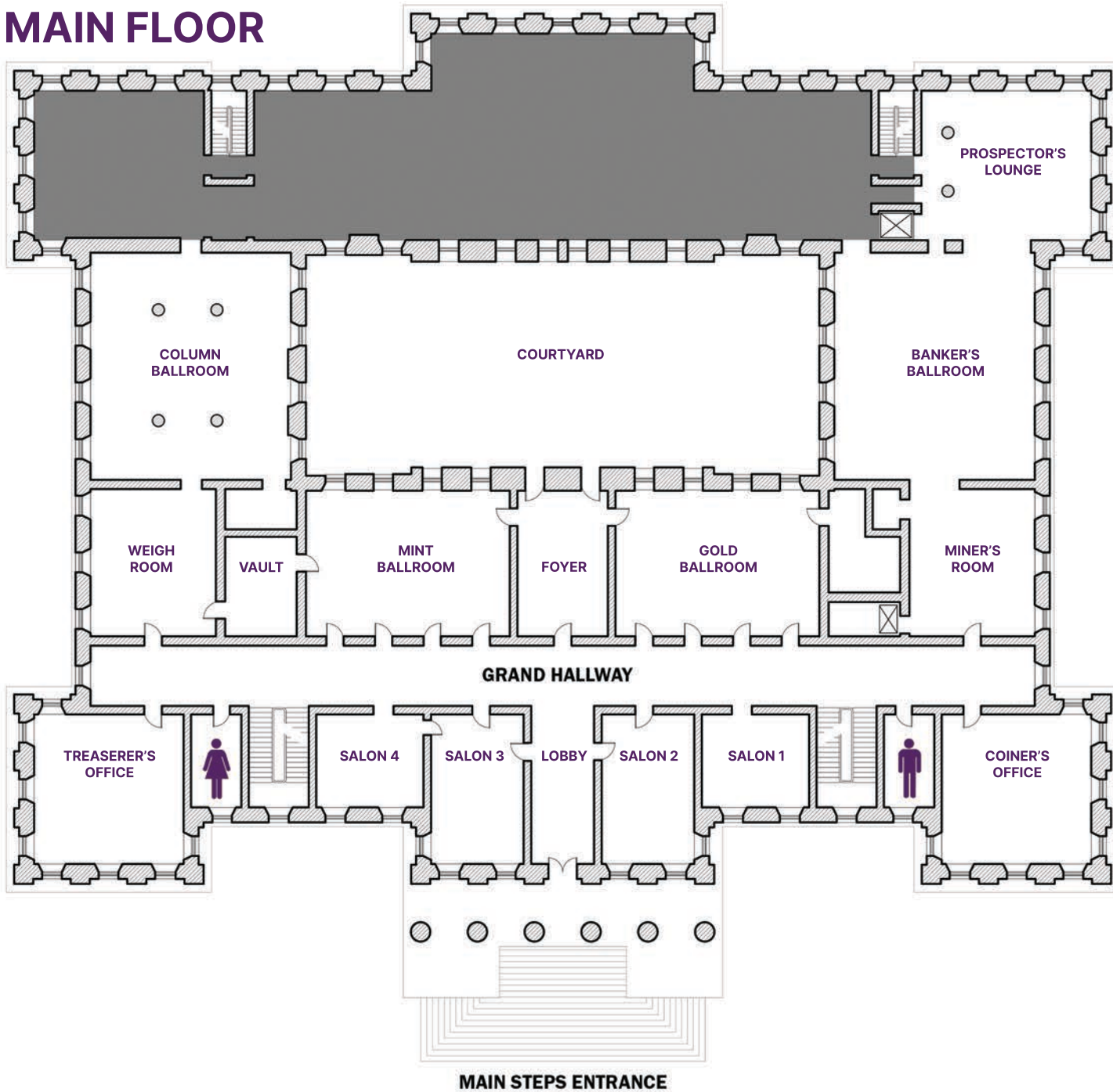

## VAULT LEVEL

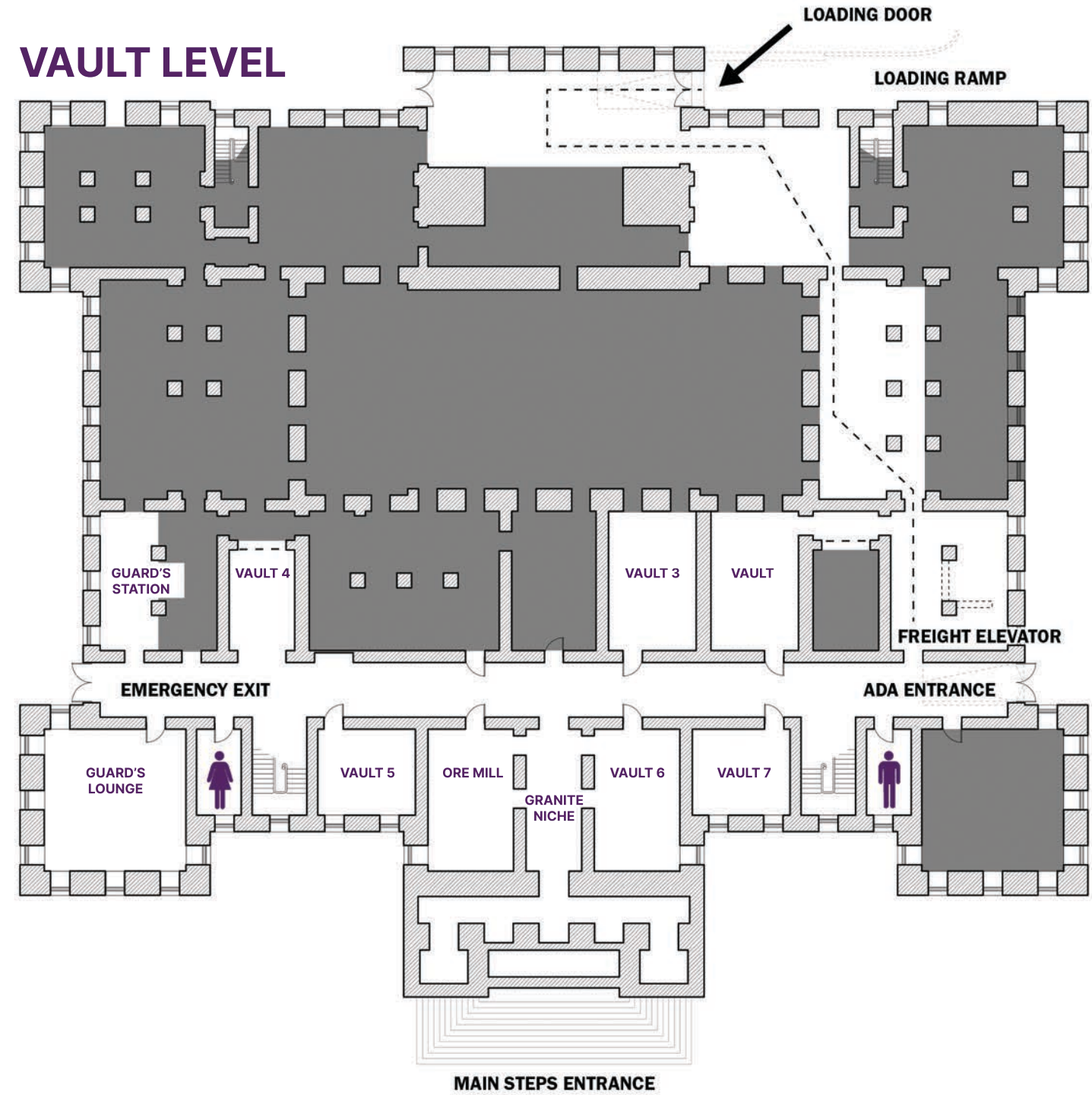

# THE PLUS FACTOR

Non Plus Ultra curates an ever-growing portfolio of distinctive Venues to host unparalleled events of all shapes and sizes. Our spaces span from historically charming to modernly chic, and can host anywhere from a few hundred people to tens of thousands.

But we're so much more than cool venues. With decades of collective event expertise and a deep understanding of the cities we serve, our team supports clients through their entire event journey.

SEE WHAT WE DO



# BOOKINGS

- 📞 415.608.2220
- ✉ events@npu.co
- 🌐 thesanfranciscomint.com
- 📍 88 5th Street  
San Francisco, CA 94103

